

# HEAVY DUTY SNATCH BLOCK – SHACKLE

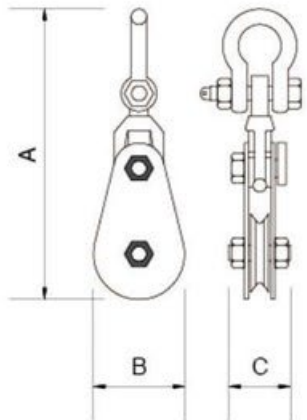

- Capacity: 2 to 85 tons
- Withstands regular towing
- Quick-pull pin enables easy cabling loading
- Both Shackle & Hook Type available
- Durable powder coat finish
- Forged spare parts enhancing quality
- Heavy-duty allows performing under extreme conditions



Model	S.W.L.	Sheave Dia (mm)	A1 (mm)	B (mm)	C (mm)	For Wire Dia (mm)	Weight (kg/pc)
TP-MLS-3*X1	2T	75	286	82	70	7-9	3.8
TP-MLS-4(1/2)*X1	4T	115	345	120	70	10-12	6.2
TP-MLS-6*X1	4T	150	399	160	70	16-18	8.3
TP-MLS-6*X1	8T	150	475	160	93	20-22	14.1
TP-MLS-8*X1	8T	200	528	210	93	20-22	18.7
TP-MLS-8*X1	15T	200	663	210	102	22-24	33
TP-MLS-10*X1	10T	250	679	260	115	24-26	34.7
TP-MLS-10*X1	12T	250	679	260	115	24-26	34.7
TP-MLS-12*X1	12T	300	767	310	133	24-26	54
TP-MLS-12*X1	15T	300	788	310	133	26-28	55
TP-MLS-14*X1	22T	355	952	365	140	28-32	109
TP-MLS-16*X1	22T	400	1019	415	140	28-32	118
TP-MLS-16*X1	30T	400	1126	415	155	32-35	164
TP-MLS-20*X1	30T	500	1256	514	162	32-35	208
TP-MLS-24*X1	50T	600	1525	625	240	46-50	418
TP-MLS-30*X1	85T	760	1910	800	288	56-64	840