

CLEVIS SLING HOOK WITH LATCH

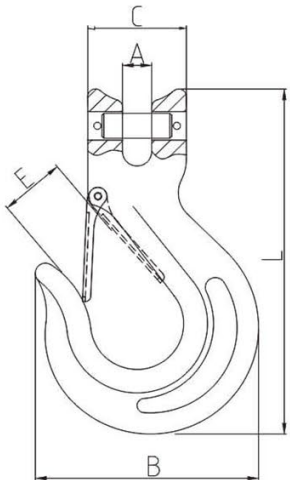

- Forged super alloy steel; Quenched & Tempered
- Suitable for EN812-2 G80 Chain
- 100% Magnaflux Crack Detection
- Individually proof-tested at 2.5X Working Load Limit
- Fatigue tested at 1.5X Working Load Limit for 20,000 cycles
- Surface Finish: Powder Plastified



Model	W.L.L.	B.L	A±2 (mm)	B±2 (mm)	E±2 (mm)	C±3 (mm)	L±3 (mm)	Weight (lbs/pc)
8-TP816-1/4	3500LBS	14000LBS	11.5	89	29	42	137.5	1.10
8-TP816-3/8	7100LBS	28400LBS	14.5	117	38	52	179	2.65
8-TP816-1/2	12000LBS	48000LBS	17.8	139	47	61	217.5	4.96
8-TP816-5/8	18100LBS	72400LBS	28.8	161.5	52	70	253	8.15
8-TP816-3/4	28300LBS	113200LBS	24.5	187	56	82.6	294	12.12

Above Working Load Limit is based on side pull