

CLEVIS LINK

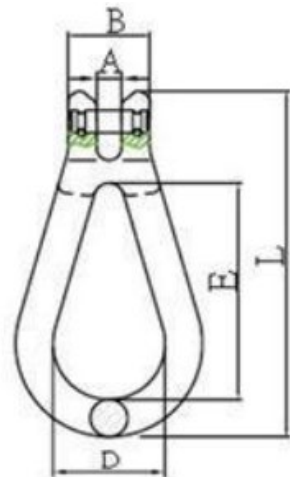

- Forged super alloy steel; Quenched & Tempered
- Suitable for EN812-2 G80 Chain
- 100% Magnaflux Crack Detection
- Individually proof-tested at 2.5X Working Load Limit
- Fatigue tested at 1.5X Working Load Limit for 20,000 cycles
- Surface Finish: Powder Plastified



SIZE	WWL (Tons)	BL (Tons)	Dimension in mm.					Weight (Kg)
			A±0.5	B±0.5	D±0.3	E±2	L±2	
7-8	2	8	10	32.8	45	87	139	0.53
10	3.15	12.6	12	42	60	108	174	0.74
13	5.3	21.2	16.5	55.5	66.5	137.5	228	1.76
16	8	32	19	68	72	165	264	2.8
18	10	40	23	73	98	185	317	3.5