

CLEVIS SLING HOOK WITH CAST LATCH

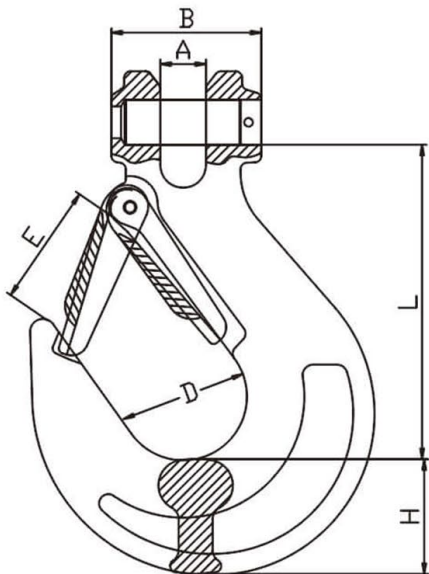

- Forged super alloy steel; Quenched & Tempered
- Suitable for EN812-2 G80 Chain
- 100% Magnaflux Crack Detection
- Individually proof-tested at 2.5X Working Load Limit
- Fatigue tested at 1.5X Working Load Limit for 20,000 cycles
- Surface Finish: Powder Plastified
- With Cast Latch



Model	W.L.L.	B.L	A±0.5 (mm)	B±1.5 (mm)	D±1 (mm)	H±2 (mm)	L±1 (mm)	E±2 (mm)	Weight (kg/pc)
8-TP815-06	1.12T	4.48T	8	32	35	23	76	26	0.32
8-TP815-7/8	2T	8T	9.5	37	37	25	86.4	29	0.48
8-TP815-10	3.15T	12.6T	12.5	49	46	31	104	39	0.95
8-TP815-13	5.3T	21.2T	16.5	56.5	56	42.5	128	47.5	1.80
8-TP815-16	8T	32T	21.5	70.5	60	54	150	56	3.40
8-TP815-20	12.5T	50T	24	77	79	58	180	59	6.00
8-TP815-22	15T	60T	26	91	101	62	213	72	10.4
8-TP815-26	21.2T	84.8T	30	117	115	75	250	101	14.5
8-TP815-32	31.5T	126T	35	150	140	88	317	124	27.0