

# HEAVY DUTY SNATCH BLOCK – HOOK

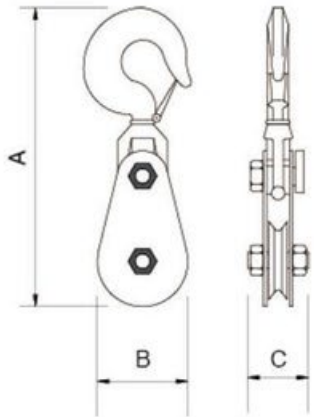

- Capacity: 2 to 85 tons
- Withstands regular towing
- Quick-pull pin enables easy cabling loading
- Both Shackle & Hook Type available
- Durable powder coat finish
- Forged spare parts enhancing quality
- Heavy-duty allows performing under extreme conditions



Model	S.W.L.	Sheave Dia (mm)	A1 (mm)	B (mm)	C (mm)	For Wire Dia (mm)	Weight (kg/pc)
TP-MH-3*X1	2T	75	292	82	70	7-9	3.9
TP-MH-4(1/2)*X1	4T	115	358	120	70	10-12	6.2
TP-MH-6*X1	4T	150	412	160	70	16-18	8.4
TP-MH-6*X1	8T	150	498	160	93	20-22	14.1
TP-MH-8*X1	8T	200	549	210	93	20-22	19
TP-MH-8*X1	15T	200	672	230	102	22-24	34
TP-MH-10*X1	10T	250	695	260	115	24-26	36
TP-MH-10*X1	12T	250	701	260	115	24-26	36
TP-MH-12*X1	12T	300	797	310	133	24-26	56
TP-MH-12*X1	15T	300	800	310	133	26-28	58
TP-MH-14*X1	22T	355	960	365	140	28-32	112
TP-MH-16*X1	22T	400	1027	415	140	28-32	122
TP-MH-16*X1	30T	400	1085	415	155	32-35	170
TP-MH-20*X1	30T	500	1177	514	162	32-35	213
TP-MH-24*X1	50T	600	1445	625	240	46-50	408
TP-MH-30*X1	85T	760	1960	800	288	56-64	810